

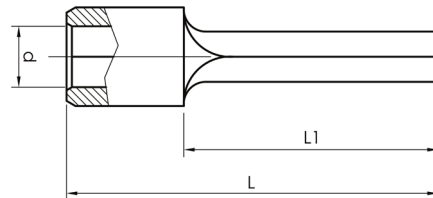

# ELPRESS®

## Product Datasheet



### Pin terminals 0.25 - 6 mm<sup>2</sup>

mm <sup>2</sup> (Cu)	AWG Cu	Name	W	d	L	L1	s	Neck type	Pcs/pack	Tool
0,25-0,75	24-20	B0819SR	1,8	1,3	17,5	12	7	Brazed	100	DKB0325
0,75-1,5	20-16	B1519SR	1,7	1,8	17	12	7	Brazed	100	DKB0325, DKB0760
1,5-2,5	16-14	B2519SR	1,9	2,4	17	12	8	Brazed	100	DKB0325, DKB0760
4-6	12-10	B4630SR	2,7	3,4	20,8	14	9	Brazed	100	DKB0760

s = strip length



# ELPRESS®